



Callahan's  
Beach Park

LONG ISLAND SOUND

Entrance  
Alternative 5

Maintenance  
Alternative 1

Maintenance  
Alternative 2

Maintenance  
Alternative 3

Entrance  
Alternative 4

25A

**Legend**

- |                  |        |  |                      |
|------------------|--------|--|----------------------|
| Maintenance Area | Orange | Tee  | Yellow               |
| Alternative 1    | Yellow | Fairway  | Light Green          |
| Alternative 2    | Purple | Green  | Dark Green           |
| Alternative 3    | Pink   | Sand Trap  | Light Brown          |
| Entrance Road    | Red    | Gov. Alfred E. Smith<br>Sunken Meadow State Park | Dark Green           |
| Alternative 4    | Red    | local park                                       | Light Green          |
| Alternative 5    | Blue   | Building   | Grey                 |
| Stream           | Blue   | Boardwalk  | Dark Brown           |
| road             | Grey   | Parking Lot                                      | Dark Grey            |
| highway          | Black  | Beach  | Light Yellow         |
| Trail            | Red    | Water  | Blue                 |
| Sidewalk         | Grey   | Wetland  | Blue with wavy lines |

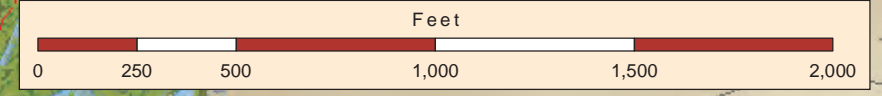

Master Plan

Figure #16

**Golf Course Maintenance**  
**Governor Alfred E. Smith/  
 Sunken Meadow State Park**

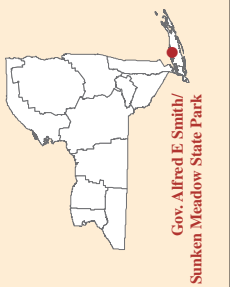

Gov. Alfred E. Smith/  
 Sunken Meadow State Park

Map produced by NYSOPRHP GIS Bureau, October 03, 2014.





Source: Esri, DigitalGlobe, GeoEye, i-cubed, USDA, USGS, AEX, Getmapping, Aerogrid, IGN, IGP, swisstopo, and the GIS User Community

Master Plan

Figure #17

**Conceptual Plan – Field 1 and 2  
Governor Alfred E. Smith/  
Sunken Meadow State Park**

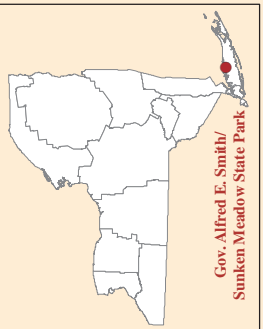

Gov. Alfred E. Smith/  
Sunken Meadow State Park

Map produced by NYSOP/HGIS Bureau, October 03, 2014



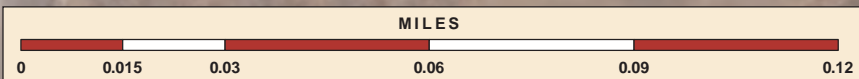

Source: Esri, DigitalGlobe, GeoEye, i-cubed, USDA, USGS, AEX, Getmapping, Aerogrid, IGN, IGP, swisstopo, and the GIS User Community

# Conceptual Plan – Field 1 Governor Alfred E. Smith/ Sunken Meadow State Park



Gov. Alfred E. Smith/  
Sunken Meadow State Park

Map produced by NYSOP/HGIS Bureau, October 03, 2014



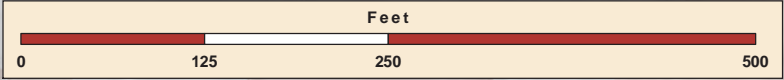
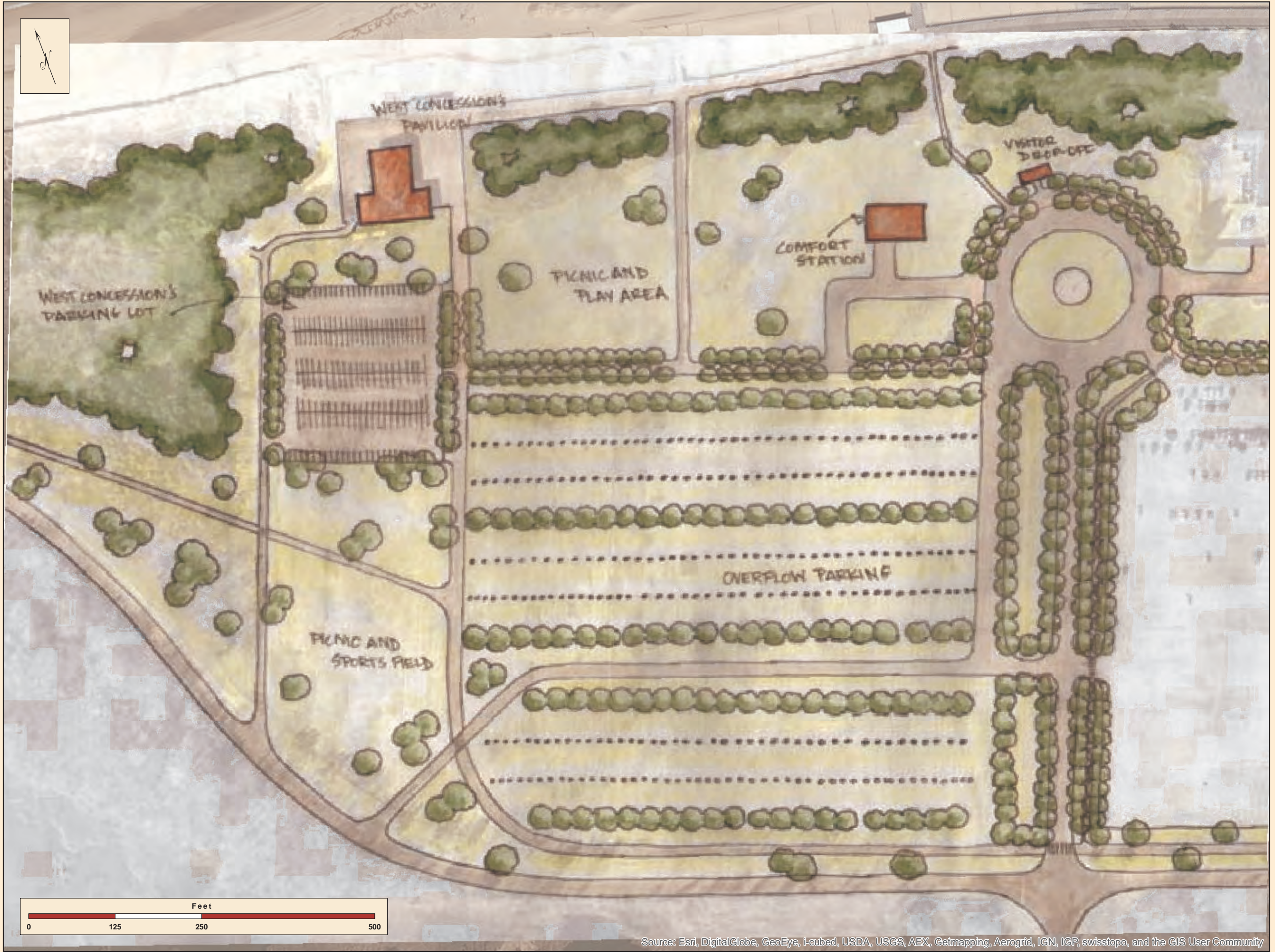

Source: Esri, DigitalGlobe, GeoEye, i-cubed, USDA, USGS, AEX, Getmapping, Aerogrid, IGN, IGP, swisstopo, and the GIS User Community

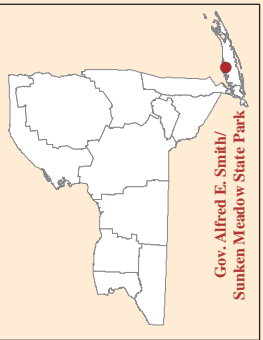

Gov. Alfred E. Smith/  
Sunken Meadow State Park

**Conceptual Plan – Field 2  
Governor Alfred E. Smith/  
Sunken Meadow State Park**

Master Plan

Figure #19





Master Plan

Figure #20

# Conceptual Plan – Field 4 Governor Alfred E. Smith/ Sunken Meadow State Park

Map produced by NYSOPH/IGIS Bureau, October 03, 2014

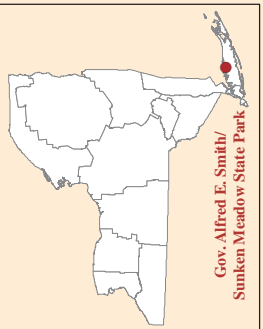

Gov. Alfred E. Smith/  
Sunken Meadow State Park





Source: Esri, DigitalGlobe, GeoEye, i-cubed, USDA, USGS, AEX, Getmapping, Aerogrid, IGN, IGP, swisstopo, and the GIS User Community

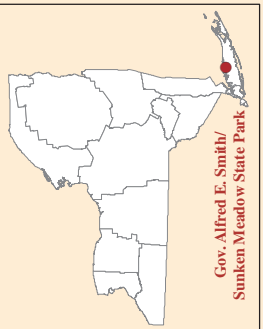

Gov. Alfred E. Smith/  
Sunken Meadow State Park

# Conceptual Plan – Field 5 Governor Alfred E. Smith/ Sunken Meadow State Park

Map produced by NYSOP/HGIS Bureau, October 03, 2014

Master Plan

Figure #21



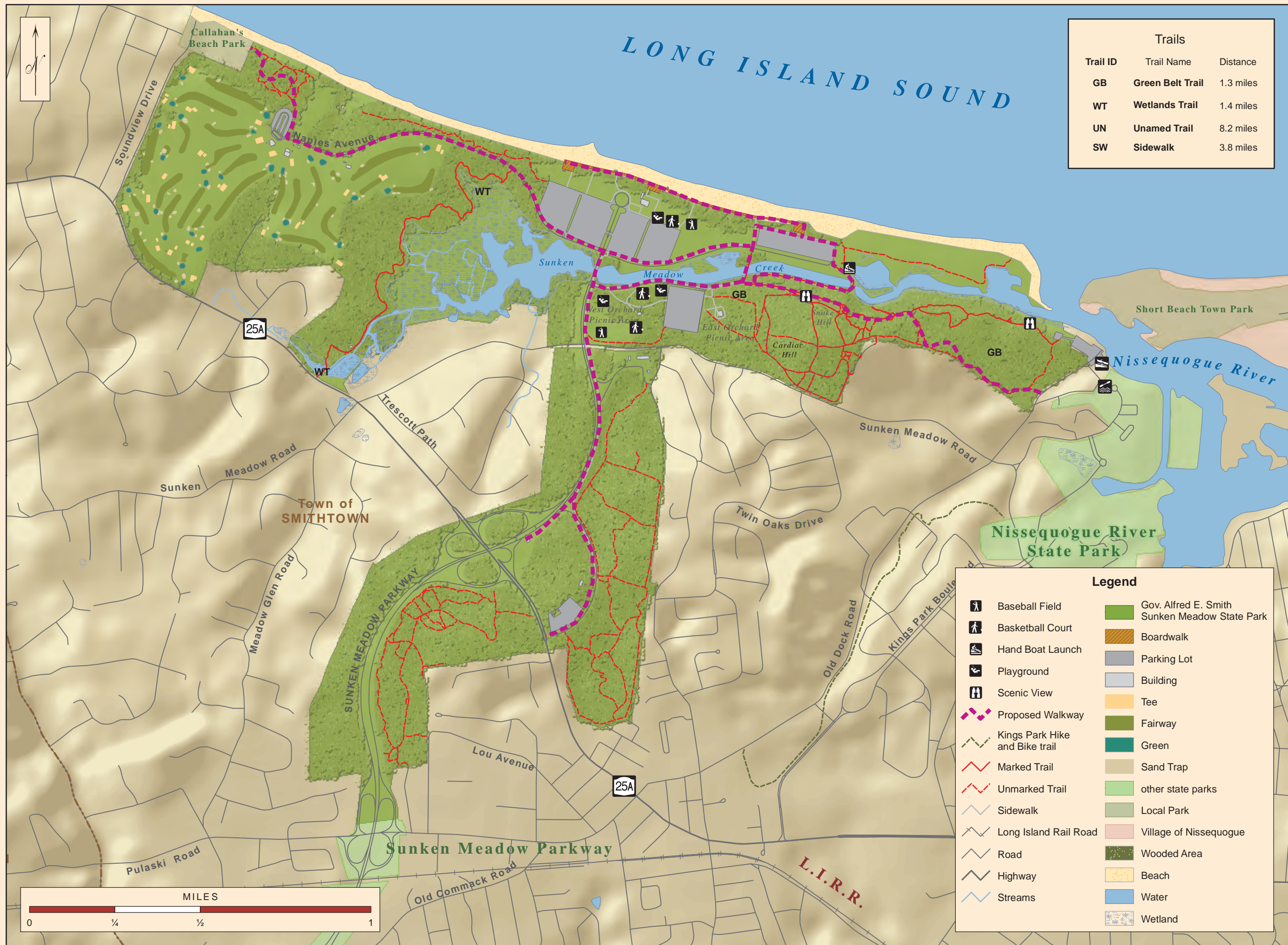

Trails		
Trail ID	Trail Name	Distance
GB	Green Belt Trail	1.3 miles
WT	Wetlands Trail	1.4 miles
UN	Unnamed Trail	8.2 miles
SW	Sidewalk	3.8 miles

Legend	
	Baseball Field
	Basketball Court
	Hand Boat Launch
	Playground
	Scenic View
	Proposed Walkway
	Kings Park Hike and Bike trail
	Marked Trail
	Unmarked Trail
	Sidewalk
	Long Island Rail Road
	Road
	Highway
	Streams
	Gov. Alfred E. Smith Sunken Meadow State Park
	Boardwalk
	Parking Lot
	Building
	Tee
	Fairway
	Green
	Sand Trap
	other state parks
	Local Park
	Village of Nissequogue
	Wooded Area
	Beach
	Water
	Wetland

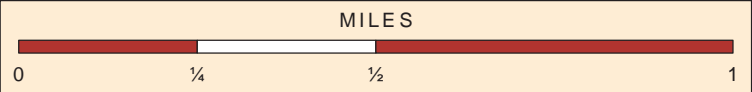

Master Plan  
Figure #22

# Potential Pedestrian Connections

## Governor Alfred E. Smith/ Sunken Meadow State Park

Map produced by NYSOPRHP-GIS Bureau, October 03, 2014.

