

**Cultural Resources**

- Consultation with SHPO concerning NRE structures and ground disturbing construction will continue.
- Rehabilitate the Park Manager's house into a Cultural Resource Center.
- Develop a plan for River Park structures and remnants.
- Expand education and interpretation.

**Education and Interpretation**

- Panels will be installed at key points throughout the park and will be linked to smart phone bar code technology for additional information.
- The nature center and boardwalk will be improved to include additional education opportunities.

**Trails**

**Rockland Lake Trail**

- A gravel shoulder will be placed on the edge of the asphalt pathway for runners.

**River Trail**

- Improvements will be made to eroded areas.

**Trails**

**The Long Path**

- Improvements will be made to reduce erosion on steep grades and avoid moist areas.

**Cultural Resources**

**Invasive Species Management**

- Management strategies will be developed for The Park Complex.

**Deer Management**

- Management strategies will be developed for The Park Complex.

**Designations**

**Bird Conservation Area (BCA)**

- A BCA is designated for all portions of The Park Complex with the exception of the golf courses and developed areas surrounding Rockland Lake.

**Park Office**

- Improvements are made to bring the office up to current standards.

**Bathhouse**

- Improvements are made to bring the bathhouse up to current standards and improve patron's experience.

**North Pool**

- The pool will be rehabilitated and made ADA accessible. A spray park will replace the former children's pool.

**Nature Center and Comfort Station**

- Phase 1 - Renovate and improve the existing center.
- Construct a comfort station for year-round use near the Nature Center.

**Nature Center**

- Phase 2 - Construct a classroom/meeting space and playground.

**Parking Lot 6**

- Comfort station is renovated.

**Knickerbocker Road**

- Repave portions in need of repair

**Picnic Area 5**

- Plant additional shade trees and construct fee booth.

**Fishing Pier**

- Develop and accessible fishing pier.

**South Entrance**

- Reconfigure the South Entrance roadway. See Figure X

**Telephone**

- Improvements will be made to the telephone system, bringing it up to present standards.

**Electric**

- Improvements will be made to the electric system.
- Electric lines should be run below grade to reduce the frequency of power outages.
- Fee booths will be upgraded to include electric.

**Stormwater**

- Drainage from Parking Lots 1 and 4 will be naturally filtered through rain gardens and detention ponds.
- Regional engineers will investigate opportunities to reuse the South Pool as a stormwater collection basin. Stormwater may be used for recreational field irrigation as needed

**Championship Golf Course**

- A new irrigation system is installed.
- The irrigation pond is dredged to increase its capacity.
- Bunkers and cart paths are improved.
- A pole barn is constructed over the tennis court area for storage and golf course maintenance.

**Equipment Storage**

- A cold storage area will be constructed on the former tennis courts for secure equipment storage.

**North Parking Lot**

- Parking Lot 1 will be reconfigured to improve patron experience and manage storm water through the use of porous pavement.
- Portion of this lot will be used as a recreational field and for overflow parking as needed.
- Parking lot will be screened from view from Rockland Lake Road through the use of native vegetation and berms.

**Wastewater Treatment Plant**

- The former wastewater treatment plant will be removed.
- A covered salt storage area will be constructed.

**North Maintenance Area**

- The heated shop is expanded.
- A wash pad is constructed
- Small covered area constructed for equipment storage.

**Parking Lot 2**

- Construct a basketball court on the north portion of the lot and/or a playground adjacent to the lot.

**Landing Road Parking Lot**

- Reconstruct a former parking lot on Landing Road. See Figure X.

**Landing Road**

- Stabilize culvert

**Cultural Resource Center**

- The current park manager's house located at end of Landing Road will be converted into a cultural resource center and restroom facility.

**Landing Road Pathway**

- A paved pathway will be constructed to connect upper Landing Road to the River Trail

**Reservable Group Shelter**

- A group shelter will be constructed adjacent to Parking Lot 3.
- The associated parking lot will be reservable with the shelter.

**South Maintenance Area**

- The heated shop area is eliminated.
- Winter maintenance is coordinated from the North Maintenance Area.

**South Recreation Area**

- Replace the South Pool
- Reconfigure to include space for a wide variety of sports.
- Staff will investigate opportunities for stormwater storage or filtration below ground in the former pool for sports field irrigation. See Figure X.

**Executive Golf Course**

- A new irrigation system is installed.
- The irrigation pond is dredged to increase its capacity.
- Bunkers and cart paths are improved.

**Nyack Bathhouse**

- Continue to rent to large groups.
- Remove hazard trees above bathhouse.

**Nyack Beach**

- Seawall and retaining walls - Repair in place.

**IMPLEMENTATION PRIORITY LEVEL**

- Priority 1
- Priority 2
- Priority 3

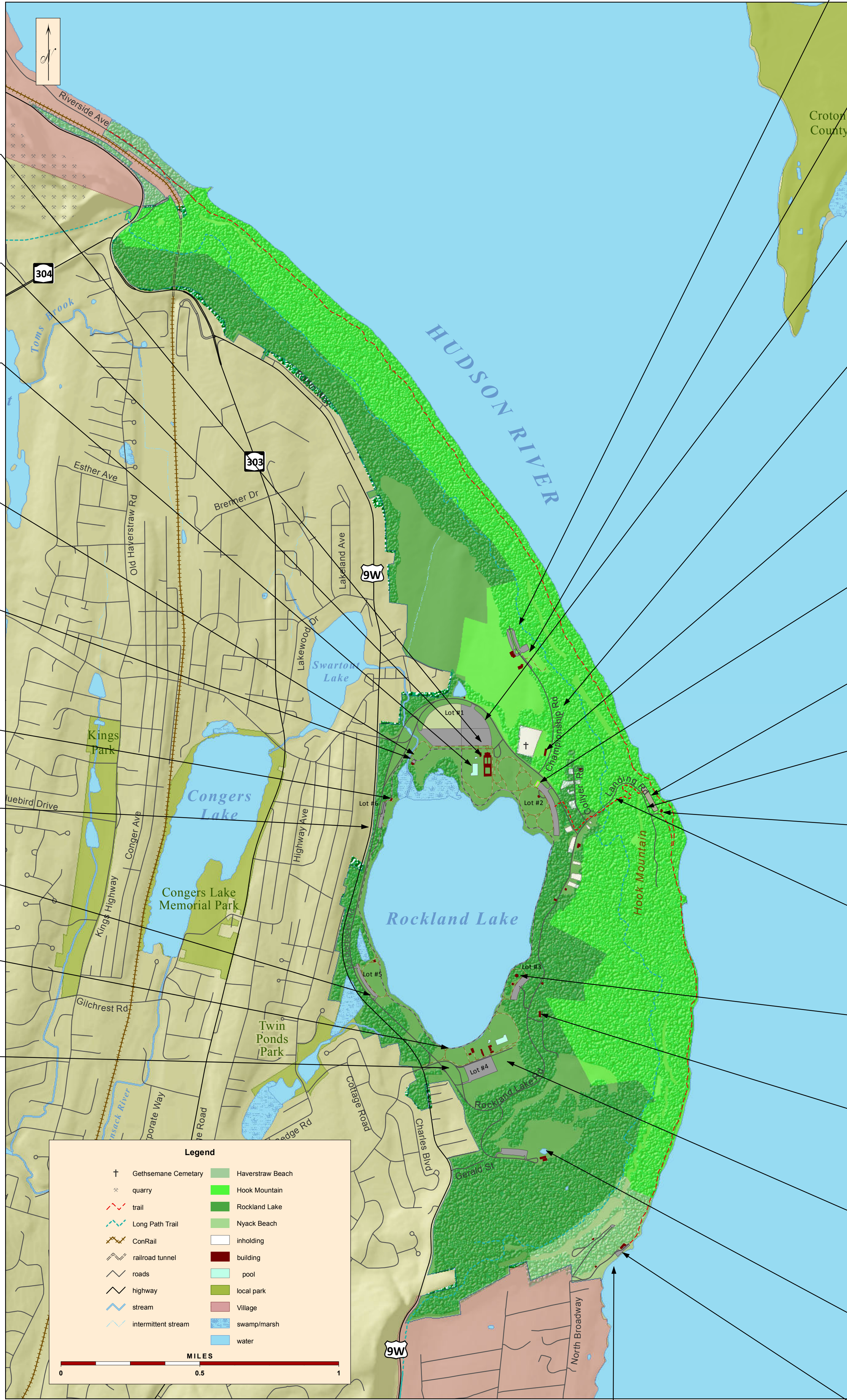

# Draft Master Plan

## Rockland Lake State Park Complex

Map Produced by NYSORHP GIS Unit, June 17, 2013.

